

ULB-M No Blind Zone Glass Plate Level Gauge

Summary

The glass plates are staggered on both view sides of ULB-M no blind zone glass plate level gauge. Level can be continuous observed, both upper and lower flanges connecting to vessel are within visual range.

Main technical parameters

Range (the distance between the flanges' center L): 500mm, 800mm, 1100mm, 1400mm, 1700mm;

Visual range: $H \geq L$;

Nominal pressure: $\leq 4.0\text{MPa}$;

Operating temperature: $-20^{\circ}\text{C} \sim +250^{\circ}\text{C}$;

Wetted material: 20, 304, 316 or on request

Non-wetted material: Carbon steel

Heating steam jacket joints: R3/8 (male thread) or on request;

Heating steam pressure: $\leq 1\text{MPa}$;

Flange: HG/T20592-2009, HG/T20615-2009 or on request;



Model selection table

Model	Name	Application
ULB-MA	Flange without valve type	For colorless transparent liquid, light better place
ULB-MB	Flange with valve model	
ULB-MAE	Flange without valve type with heating	Sticky and easily frozen medium
ULB-MBE	Flange with valve type with heating	

ULB-M No Blind Zone Glass Plate Level Gauge

Outline and installation dimensions

Structure and size

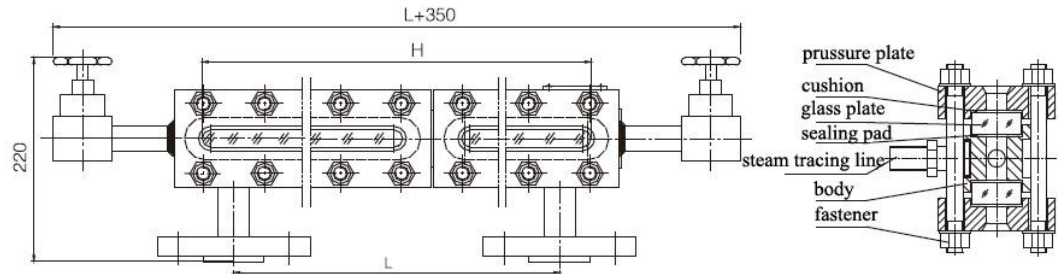

ULB-MA Type glass plate level gauge

Section

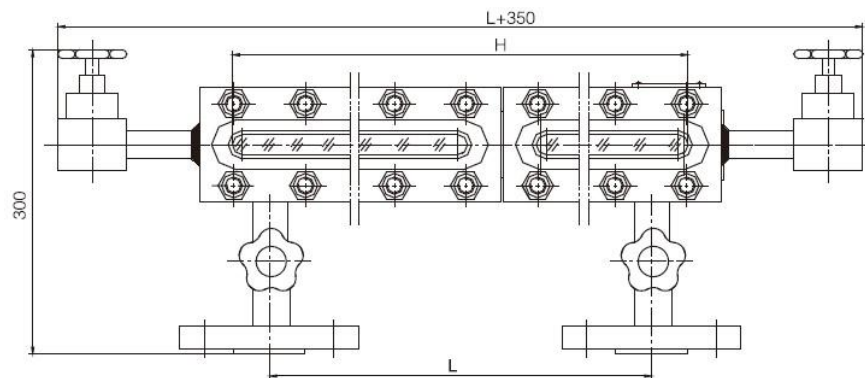

ULB-MB Type glass plate level gauge

Order requirements

- ◆ Model and specification
- ◆ Distance between flanges' center
- ◆ Medium
- ◆ Operating pressure
- ◆ Operating temperature
- ◆ Flange standard
- ◆ Wetted material
- ◆ Other requirements